

Instructions for the Adjustment of ELB 06.XXX.Y.0 Electromagnetic Brake

This manual provides the instructions for the adjustment of ELB 06.XXX.Y.0 electromagnetic brake, where

- XXX is the diameter of the brake wheel which the brake is determined for (e.g. 240,320,...)
- Y is the code for supply voltage (1 is 200V, 2 is 24V, 4 is 48V)

1. Electromagnetic Brake Adjustment

Attach the brake to the holders by means of screws 5. The brake lining 3 touches down the brake wheel. Remove the screw 6, serving during transport (in the case of service work on the drive, the screw 6 can be used for mechanical brake release). Adjust the air gap $T=0.5$ mm between the anchor 2 and body 1 by means of a feeler gauge (sheet of specified thickness). Tighten the screws 5 in order to move the body 1 to the anchor 2 until the air gap between them is defined only by the feeler gauge. After the air gap is adjusted, secure the body position by the screws 4 and check the air gap again. If the air gap changes a lot by tightening the screws 4, loosen them and adjust the air gap again by means of the screws 5 and secure with the screws 4. If the anchor during the brake release falls on the body twice, the screws 5 have to be slightly tightened after loosening the screws 4 on the side opposite the first fall of the anchor on the body. Secure the adjusted brake by retightening the screws 4. When adjusting the air gap, be particular about equal adjusting and check each corner of the electromagnet.

WARNING: The screw 6 must not be on the brake during operation! Failing to observe it could result in the brake malfunction.

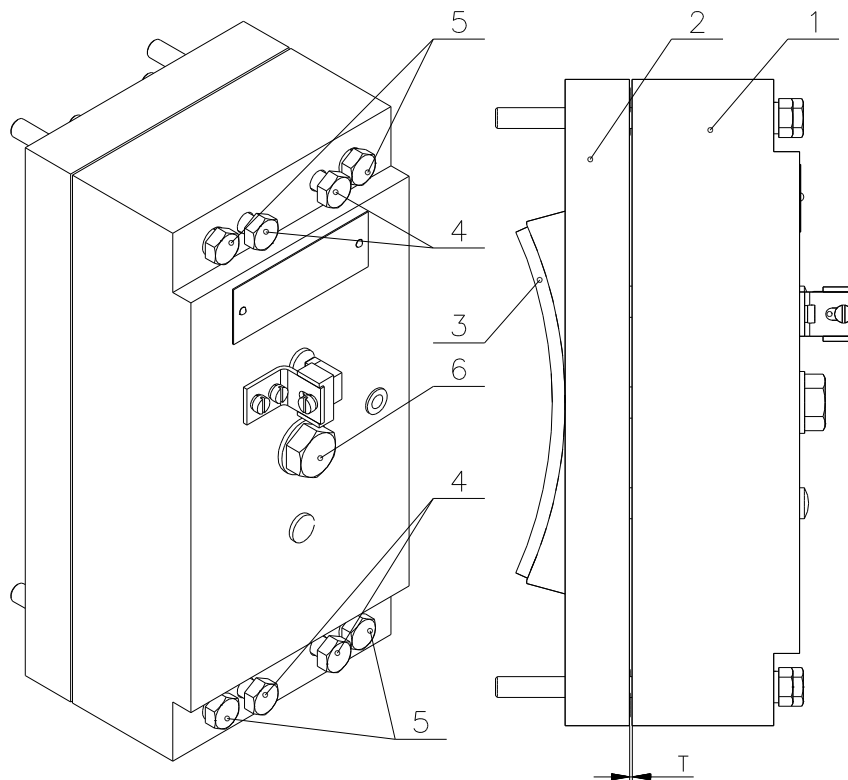

2. Microswitch Adjustment

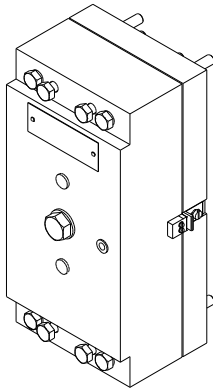

Brake with the switch on the body side.

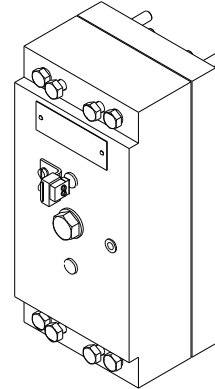

Brake with the switch on the body front side.

Brake with the switch on the body front side.

Loosen the screw 8 and move the switch 6 until the correct position is adjusted so that the switch indicates the anchor position, whether the brake is released or put on.

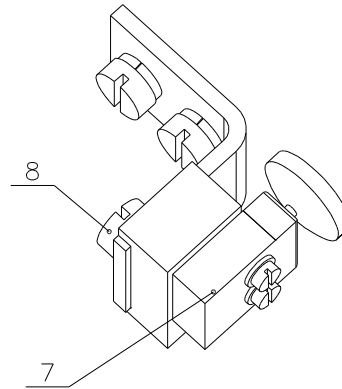

Brake with the switch on the body side.

Loosen the screw 9 and move the stop of the switch 10 to adjust the correct position so that the switch indicates the anchor position, whether the brake is released or put on.

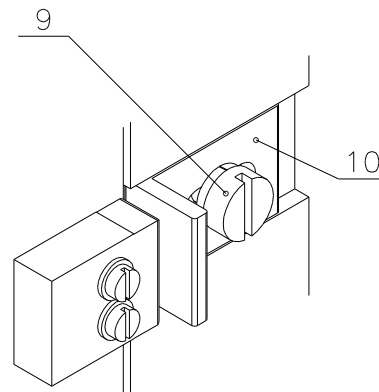

WARNING: Check the correct function of the switch at each adjustment of the air gap between the body and the anchor of the electromagnet and adjust it, if necessary.